

**TRS-1675**



12520 East FM 917 • Alvarado, Texas 76009  
817.473.2233 • toll-free 800.651.5102 • fax 817.473.9742  
[www.tesmec.com](http://www.tesmec.com)

24050 Grassobbio (BG) Italy • via Zanica 17/O  
tel +39 035 423.2911 • fax +39 035 335.664  
[www.tesmec.it](http://www.tesmec.it)

### GENERAL

#### CHAINSAW

Weight: 12' (3.66 m) Boom with 72" (184 cm) rotary cutters and Crumshoe: 273,150 Lbs. (123,900 kg)  
Maximum Configuration Weight: 273,150 Lbs. (123,900 kg)  
Transport length with 20' Boom and Guard: 59'-6" (18.13 m)  
Height: w/Cab: 13'-3" (4.04 m)  
Width: 15'-6" (3.96 m) With 30" (76.2 cm) Track Pads

#### BUCKET

Weight: Approx. 262,000 Lbs. (118,842 kg)  
Height: Tractor w/Cab-13' 3" (4.0 m) with cab elevated-16' 3" (4.95 m)  
Transport length: 54' 0" (16.45 m)  
Transport Width: 14' 6" (4.42 m) with 30" (76cm) Track Pads.  
Transport Height: 16' 9" (5.1 m) (over Boom with 3) Lower buckets removed and single grouser pads).

#### ROCK HAWK

Weight: 365,000 Lbs. (165,563 kg) Rock Hawk  
Height: w/Drum Guard 14' 5" (4.40 m), with cab elevated - 16' 5" (5.00 m).  
Transport length with Drum Guard: 45' 4" (13.82 m).  
Transport Width: 174" (442 cm)  
Transport Height: 13' 5" (4.10 m) (over cab and single grouser pads).

### STANDARD FEATURES

Pressurized, cab with air conditioning, heating, and sound suppression  
Elevating cab module with roll over protection (ROPS)  
Creep control: Operator selectable digging pressure, automatic operation  
Battery Box and Toolbox with locking door  
Engine doors with security locks  
Fuel and Hydraulic Tank: Aircraft quality locking caps  
Gearboxes and Hydraulic Tanks: Pressurized with 5 PSIG filtered breathers  
Flywheel Gearboxes: shaved, helical gearing, case hardened for extreme shock ability  
Vibration isolator: mount: used on engine, radiator, oil cooler, and exhaust silencer

### ENGINE

Model: Cummins GSK-19  
Description: Turbocharged and after cooled  
Number of cylinders: 6 In-Line  
Maximum load RPM: 2100  
Maximum gross horsepower at no load: 760 (567 kW)  
Cooling Medium: Liquid  
Cooling Rating: Adequate for 130° F (54.4° C) ambient air temperature @ 8000 ft. (2438 m) altitude  
Air cleaner: Dry type, 2 stage with dual precleaner  
Oil filter: Full flow canister  
Fuel filter: Primary and secondary  
Electrical system: 12V/24V  
Fuel tank capacity: 430 gal. (1630 L)  
Fuel consumption at full load: 36 gal./hr. (136 l/hr)  
Operating range: 11.9 hours

### OPTIONAL ENGINE

Model: Caterpillar C-27 ACERT  
Description: Turbocharged and after cooled  
Number of cylinders: V-12  
Maximum no load RPM: 2,100  
Maximum gross horsepower at no load: 800 (597 kW)  
Cooling Medium: Liquid  
Cooling Rating: Adequate for 130° F (54.4° C) ambient air temperature @ 8000 ft. (2438 m) altitude  
Air cleaner: Dry type, Centrifugal precleaner with primary and secondary filters  
Oil Filter: Full flow canister  
Fuel Filter: Primary and Secondary  
Electrical system: 24V Starting, 12V Controls  
Fuel tank capacity: 430 gal. (1,630 L)  
Fuel consumption at full load: 38.7 gal/hr. (146 l/hr)  
Operating range: 11.1 hours

### HYDRAULIC SYSTEM

Type: Pressure and flow compensated (Load Sensing)  
Pump flow maximum: 65 GPM (245 l/min.)  
Pressure setting: 2500 PSI (172 Bar)  
Oil tank capacity: 235 gallons (889.4 L)  
Oil type: Texaco code 1855, Type "F"

### CRAWLER DRIVE

Dual path, hydrostatic drive, planetary transmissions capable of full counter rotation with single lever steering, single lever direction  
Infinitely variable speed: Forward and reverse  
High Range: 0 - 2.1 Mph (3.36 km/hr)  
Low Range: 0 - 1.1 Mph (1.76 km/hr)  
Integral parking and service brake: Spring applied, hydraulic release, wet disc brake

### TRACKS

Overall Center to Center Track Length: 168" (4277.5 cm)  
Track pad type: double or triple grouser  
Track chain type: Caterpillar 245B\*\*  
Track chain pitch: 10.25" (26 cm)  
Track pad width: 30" (76.2 cm)

### CONVEYOR

Hydrostatic: One pump and two motors  
Description: Reversible and shiftable  
Belt speed: Infinitely variable 0-1000 FPM (0-274.3 m/min.)  
Discharge direction: right or left

#### CHAINSAW

Belt speed: Infinitely variable 0-900 FPM (0-274.3 m/min.)  
Conveyor belt width: 42" (107 cm)  
Conveyor length: 17' 0" (5.18 m) or 21' 0" (6.40 m)  
Discharge height: 8' 1" (2.46 m) or 9' 10" (3.00 m)

#### BUCKET

Belt speed: Infinitely variable 0-1000 FPM (0-305 m/min.)

Conveyor belt width: 48" (1.22 m)  
Conveyor length: 19' 0" (5.79 m)  
Discharge height: 5' 1" (1.5 m)

### TRENCHER DRIVE

#### CHAINSAW

Hydrostatic: Four pumps and two motors capable of transmitting full engine horsepower  
Infinitely variable digging chain speeds:  
Depths: 8' through 24' (2.4 m through 7.3 m) Sectional Boom  
Three Operator Selectable Digging Speed Ranges:  
0-390 FPM (0-119 m/min.)  
0-550 FPM (0-168 m/min.)  
0-710 FPM (0-216 m/min.)  
Widths: Chain: Depths:  
28"-48" (71-122cm) Dbl. Narrow (D9N) Max. 24' (7.3 m)  
40"-60" (102-152cm) Dbl. Wide (D9N) Max. 22' (6.7 m)  
54"-72" (137-183cm) Tpl. Wide (D9N) Max. 14' (4.3 m)

(Crumshoe change required at cut width greater than 52" (1.32 m) out width)

Hydraulic Digging Chain Adjustment  
Top Boom Rollers  
Conveyor Fold: Hydraulic winch  
Tailwheel diameter: 48" (122 cm)  
Headshaft diameter: 12.5" (31.8 cm)  
Cutters: Rotary carbide tipped 1-1/2" (3.8 cm) shank diameter  
Digging Chain: 67/D9N  
Optional Hydraulic Crumshoe

#### BUCKET

Hydrostatic: Four pumps and two motors capable of transmitting full engine horsepower.  
Depths: 3'-7" (1.09 m) minimum w/boom level through 10' (3.04 m)  
Widths: 3'-4" (1.0 m) through 6'-9" (2.0 m)  
Buckets: 15 or 18 buckets, 1-1/2" thick plate (59 cm)  
Digging Rim: Double (forged steel) segmented 2" plate main rim multiple drilled false rims to accept 18 or 27 buckets  
Bucket backs are standard, chain-backs optional  
Three Operator Selectable Digging Speed Ranges:  
0-6.5 RPM  
0-9.2 RPM  
0-11.9 RPM  
Cutters: Rotary carbide tipped 1-1/2" (3.8 cm) shank diameter.  
Other cutting tools and holders available to suit various conditions.

#### ROCK HAWK

Hydrostatic: Four pumps and two motors capable of transmitting full engine horsepower.  
Depth: 46" (116.8 cm)  
Width: 14' (4.27 m)  
Three Operator Selectable Digging Speed Ranges:  
0-375 FPM (0-114 m/min.)  
0-540 FPM (0-164 m/min.)  
0-700 FPM (0-213 m/min.)  
Drum tip diameter: 98" (249 cm)  
Headshaft diameter: 12.5" (31.8 cm)  
Cutters: Rotary carbide tipped 1-1/2" (3.8 cm) shank diameter.  
Chain: D9N

### OPTIONS

Cab Anti-Vandalism Window Covers  
Work Light Package: 24V, for night use  
Air Compressor  
Laser Control System Pre-Wire

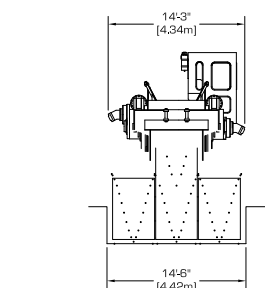
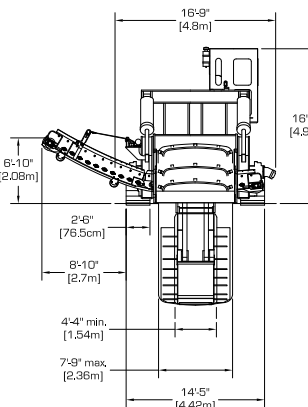
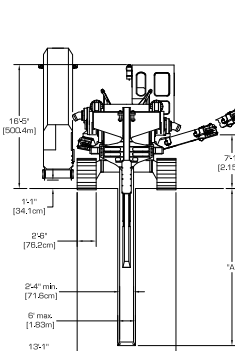

Increased cooling capacity for high temperature ambient application.  
Truck Conveyor

\*\* Caterpillar and Cat are trademarks of Caterpillar Inc.  
\*\* Cummins is a trademark of Cummins Engine Company, Inc.

